

Cilindros para vending Vending locks

Gama Mini / Mini range



Con la llave **Mini8** de perfil restringido, el operador dispondrá de un código propio o amaestramiento que le permitirá abrir todas sus máquinas aunque éstas sean de distintos fabricantes.

Características:

- Cilindro de latón.
- 8 pitones.
- Llave de alpaca plana reversible.
- Estria protegida.
- Amaestable hasta 1.700 unidades por maestra.
- Hasta 1.679.616 distintos.
- Acabado níquel.

With the **Mini8** key with restricted profile, the operator will have its own combination or masterkey suite to open all his vending machines even if these are from different manufacturers.

Characteristics:

- Brass cylinder.
- 8 pins.
- Nickel silver dimple reversible key.
- Protected profile.
- Masterkeyable for up to 1.700 units per master.
- Up to 1,679,616 different codes.
- Nickel finish.

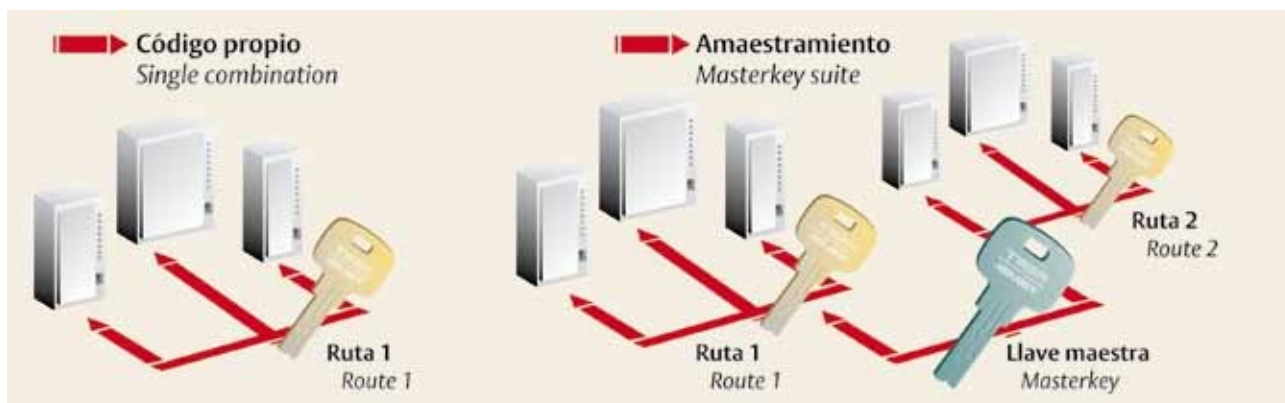

Modelo / Model

Cilindro Mini8 modelos vending / Mini8 lock, vending models

Cilindro Mini8 amaestrado / Masterkeyed Mini8 lock

Llave Mini8 / Mini8 key

Llave maestra Mini8 / Mini8 masterkey

Cilindros para vending

Vending locks

Gama Mini / Mini range

Cilindros para manetas / Locks for T-handles	Características / Features	Código / Code	Modelo / Model
	Condensa D=6.5 / Bolt D=6.5	8629BOTU03174B	Standard
	Condensa D=6.5 / Bolt D=6.5	8629BDAM03174B	2 planos / 2 flats

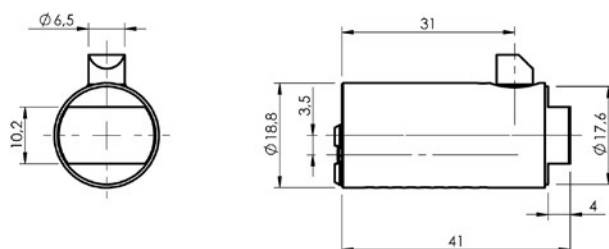
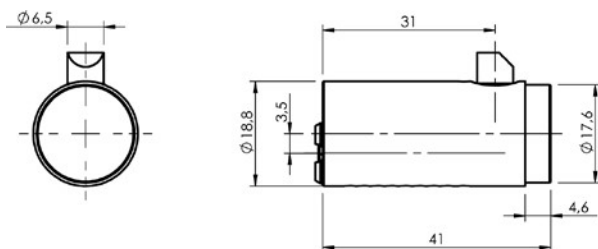

Azkoyen / Jofemar / GM Vending	Características / Features	Código / Code
	M19x1 / 90° C	8626AZJO03174B
	M19x1 / 90° S	8626AZJO04174B

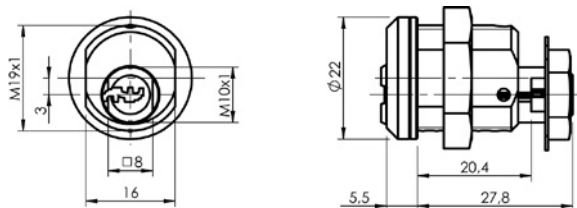

Saeco / Bianchi	Características / Features	Código / Code
	M19x1 / 90° C	86240SAEL3174B

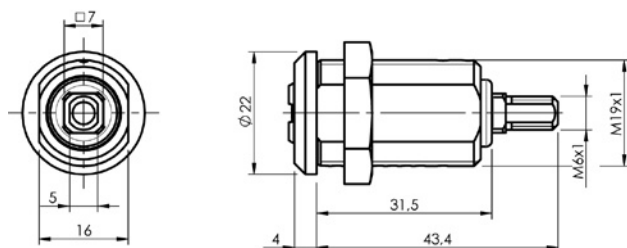

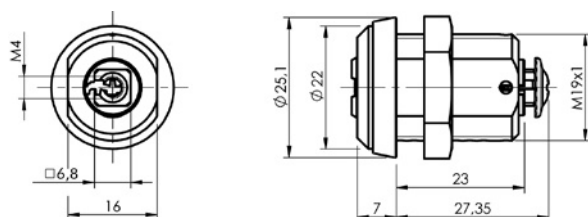

Rhea / Vendo	Características / Features	Código / Code
	M19x1 / 90° C	862408001617
	M19x1 / 90° S	862408001717



Cilindros para vending

Vending locks

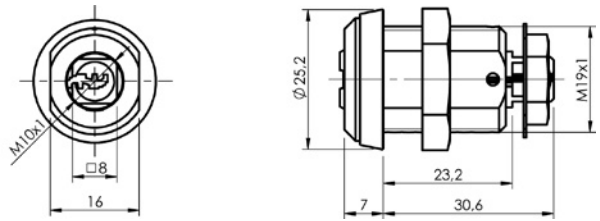
Gama Mini / Mini range

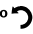
Necta	Características / Features	Código / Code
	M19x1 / 90° 	8624ZNSS03174B
	M19x1 / 90° 	8624ZNSS03274B

Sielaff	Características / Features	Código / Code
	M21x1 / 90° 	86280M2103174B

Wurtlizer	Características / Features	Código / Code
	M19x1 / 90° 	8628WURT23174B

D

Cilindros para vending

Vending locks

Manetas / T-handles

Manetas / T-handles

Código / Code

8701001

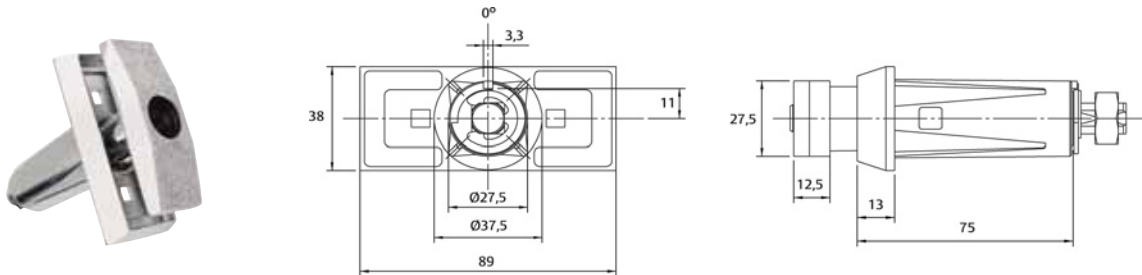

877500001000

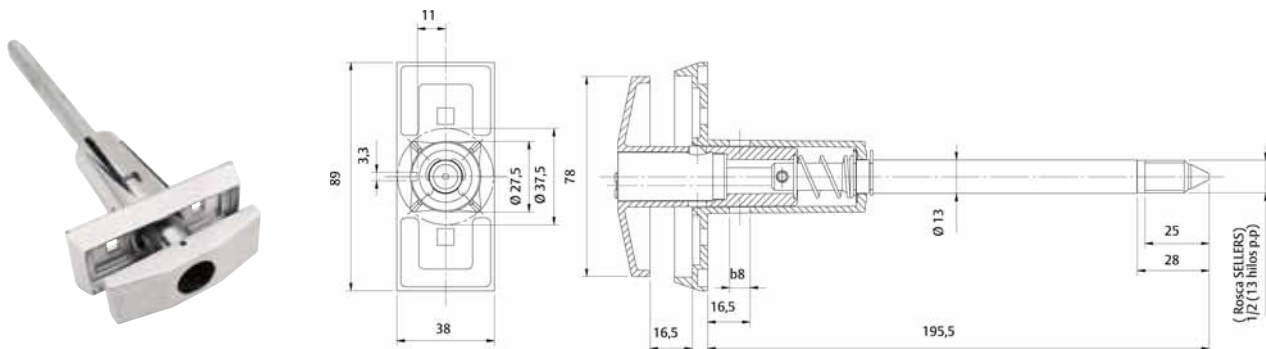

827500000020

